

Dedicated Room

(Room Floor Space must be a minimum of 8'x7')

The Mystic Tan booth should have a room dedicated solely for its use. The room floor space must be a minimum of 8' X 7'; slightly larger is better. The room floor must be level and free of obstructions. Preferred floor cover type is tile or linoleum. Carpeted floors are not recommended. Sufficient overhead room lighting is required (florescent is recommended). Your Mystic Tan booth is provided with a clear Lexan® top, which allows light inside the booth.

Refer to page 5 & 6 (Room layout Diagram #1 Original Mystic Tan Booth) and (Diagram #2 Innovation Series Mystic Tan Booth)

Equipment Shipment, Unloading and Storage

(More than one person will be required to unload)

The Mystic Tan booth is usually shipped up to one week prior to the installer's arrival. The booth is shipped in several large boxes. They will need to be unloaded and stored near or inside the dedicated Mystic Tan room. More than one person will be required to unload the equipment. Boxes can be separated and removed individually. Do not depend on the truck driver or delivery person to help with unloading the boxes. Mystic Tan requests that all boxes remain unopened. In the event that any of the boxes have been opened, Mystic Tan will not be responsible for damaged or missing parts.

Refer to page 7 (Box sizes and weights Diagram #3).

Note: Please make note of any apparent damage on the delivery receipt prior to signing and accepting the shipment. Mystic Tan will provide the appropriate tracking information allowing you to monitor the shipments estimated arrival date and time.

Equipment Training

(Arrange for the appropriate personnel to attend)

You will need to provide the appropriate personnel and time for training. The training session is a complete overview of the Mystic Tan booth and how it works. You will be trained on how to tan a customer, the day-to-day equipment operation, maintenance and equipment troubleshooting. Training is approximately 1 hour and will take place upon completion of the equipment installation, and is performed by the equipment installer. Arrange for the appropriate personnel to attend, such as a store manager or maintenance personnel. It is not necessary for everyone to attend this training, just your key individuals that will be able to train all additional employees and new hires.

General Contractor Services

To stay in compliance with city codes, you must consult with your electrical and plumbing contractors. Mystic Tan equipment is compliant with CSA and CE Certification guidelines. Local codes vary and are not the responsibility of Mystic Tan Inc.

Electrical

Mystic Tan Booth (110 VAC, 20 amp outlet):

The Mystic Tan booth requires 110 VAC, 20 amp outlet. It only requires .5 amps AC Current to operate booth. MTI-5000 requires a GFCI outlet (Ground Fault Circuit Interrupter).

Refer to page 8 (Electrical Diagram #4) also see page 12 (Diagram #9 and #10)

Compressor (110 VAC, 20 amp (dedicated):

The Air compressor requires 110 VAC, 20 amp **(dedicated)** outlet. A six-foot (6') power cord is provided with the air compressor. The use of any type of extension cord is prohibited and will void the air compressor warranty.

Refer to page 8 (Electrical Diagram #5)

Important: Under no circumstances will Mystic Tan installers be responsible for any electrical service installation.

Plumbing

Supply Line (½" ID with ¾" GHF Male Connection with on/off valve):

Important: The water supply must be turned off at the end of each day.

An in-room water supply line is required for the Automated Cleaning Cycle. The water supply line specifications are ½" ID with ¾" GHF Male Connection equipped with an on/off valve (a typical washing machine connection). The Supply Line should have a minimum of 55 pounds of pressure (8 gpm). **Note: A minimum of 55 PSI water pressure is needed from the supply line to the Mystic Tan booth to properly wash down the unit.** We recommend that the water supply to the Mystic Tan booth be turned off each night using the shut off valve. This will protect your salon from water damage should the hose connecting your booth to the water supply ever fail. The shut-off valve should be easily accessible and located at the end of your in-room water source. Using the shut-off valve located in the Mystic Tan booth will not protect the salon from water damage caused by a failed connecting hose. Mystic Tan is in not responsible for the integrity of supply line hoses. To maintain compliance with city codes, please consult with your plumbing contractor.

Refer to page 9 & 10 (Plumbing Diagram #6 & 7) also see page 12 (Diagram #9 and #10)

Drain Line (1" ID with ¾" GHF Male Connection, PVC or Copper):

An in-room drain line is required to remove rinse water from the Mystic Tan booth after each cleaning cycle. The in-room drainpipe specifications are; 1" ID with ¾" GHF Male Connection (PVC or Copper suggested). The Mystic Tan booth is equipped with a fully automatic discharge pump for water removal. The discharge pump (provided) is capable of pumping 12' in height (maximum), Height and Length: Not to exceed 60' (60' of head pressure or approximately 30 PSI). The discharge pump will also remove water at a rate of 2.8 [GPM]. A six-foot (6') drain hose is provided to connect from the drain pump to the wall connection. *Not following these guidelines will cause premature pump failure. This in turn will result in the voiding of your pump warranty.*

Refer to page 9 & 10 (Plumbing Diagram #6 & 7) also see page 12 (Diagram #9 and #10)

Note: A Backflow prevention device may be required in your municipality. The salon is responsible for consulting a qualified plumber and contractor.

Air

**Compressor room location and size: (Room - 48" Height X 30" Length X 30" Width),
(Compressor - 45"Height X 24" Length X 21" Width) - Amp Draw: 15/7.5**

The Mystic Tan booth requires compressed air for its operation; a Compressor is included with the Mystic Tan booth. Due to noise level, the air compressor should be located away from the tanning room. The air compressor should always be located in an easily accessible **ground** location. The air compressor dimensions are 45"Height X 24" Length X 21" Width) with an Amp Draw of 15/7.5. The air compressor requires periodic maintenance and should be easily accessible. A six-foot (6') power cord is provided with the air compressor. The use of any type of extension cord is prohibited and will void the air compressor warranty.

Refer to page 8 (Diagram #5)

Compressor Air line (3/8" for hose or piping lengths up to 100':

To connect compressed air to the Mystic Tan Booth from an extended location, you can either purchase a ready-made air hose of the proper length, or install air piping with connection hoses. The inside diameter (ID) should be no less than 3/8" for hose or piping lengths up to 100'. For runs over 100', ½" ID is needed. Ready-made air hoses can be found in Grainger, Home Depot, Lowes or similar industrial companies.

Refer to page 11 (Air Line Diagram #8A & #8B) also see page 12 (Diagram #9 and #10)

Remote Controller

(50' of communication cable is included)

The Mystic Tan booth is provided with a remote controller. This controller enables you to operate the unit anywhere within the dedicated room. If the Mystic Tan booth needs to be operated outside of the room, 50' of communication cable is included for remote controller operation. The Mystic Tan booth is capable of operating with an existing T-Max or Intellatan Timer controller. **Note:** Mystic Tan installers are not responsible for timer integration into an existing T-Max or Intellitan controller system.

Important: Under no circumstances will Mystic Tan installers be responsible for any air services, plumbing services, or communication cable installation.

Mystic Tan™ Pre-Installation

Salon Access

(Installer may need early access to your salon)

Because there is much to be accomplished, the installer will need full and complete access to the salon (earlier or later than your normal operating hours).

Requirements and Responsibilities Check List ✓ :

- In compliance with city codes:** Consult with your electrical and plumbing contractors.
- Unload Booth Shipment:** Appropriate personnel (no less than two) available to unload shipment from freight truck.
- Dedicated Room:** (Room Floor Space must be a minimum of 8'x7') (Ceiling height 8'-9' depending on equipment model). Room must be empty and accessible.
- Electrical:** (Mystic Booth): Dedicated room must have a 110 VAC, 20 amp outlet. MTI-5000 requires a GFCI outlet (Ground Fault Circuit Interrupter).
- Electrical:** (Compressor): Dedicated space must have 110 VAC, 20 amp (**dedicated**) outlet.
- Plumbing:** (Supply Line): In-room cold water service with 55 pounds of pressure (8 gpm). Equipped with an on/off valve and a 3/4" male (typical washing machine hose connection). **Note:** A minimum of 55 PSI of water pressure is needed from the supply line to the Mystic Tan booth to properly wash down the unit. **Important: The water supply must be equipped with a shut-off valve.**
- Plumbing:** (Supply Line Hose): In room supply line - 6' to 8' long, 1/2" ID, high pressure supply hose (typical washing machine hose). *Mystic Tan is in not responsible for the integrity of supply line hoses.*
- Plumbing:** (Drain Line): In room drainpipe - 1" ID with 3/4" GHF Male Connection PVC or Copper. **Note:** The discharge pump (provided) is capable of pumping 12' in height (maximum), Height and Length: Not to exceed 60'.
- Compressor:** (Location): A dedicated location with a minimum space of 48" tall X 30" long X 30" wide (Ground level). With required electrical specifications.
- Compressor:** (Air line): Air supply line from compressor to tanning room with connections. Ready-made 3/8" ID air hose to appropriate length with connections (see page 11, diagram 8A). If using air piping, use two (2) air hoses of appropriate length with required connections (see page 11, diagram 8B).
- Salon Access:** Arrangements have been made for access to the salon with installer.
- Bath Towels:** Bath Towels for customers and training sessions (12 minimum).
- Staff available for training:** Key individuals such as Store Manager or Maintenance Personnel.

I agree that all of the requirements listed above have been completed.

Salon Name _____ City: _____ State: _____

Salon Owner Signature _____ Date: _____

Important: No delivery and installation schedule will be made until all requirements are completed. After completion, you must sign, date and fax the Requirements and Responsibilities Check List to Mystic Tans Sales Coordinator.

Fax # 972-267-5551. Or call 877-668-8826 x. 131

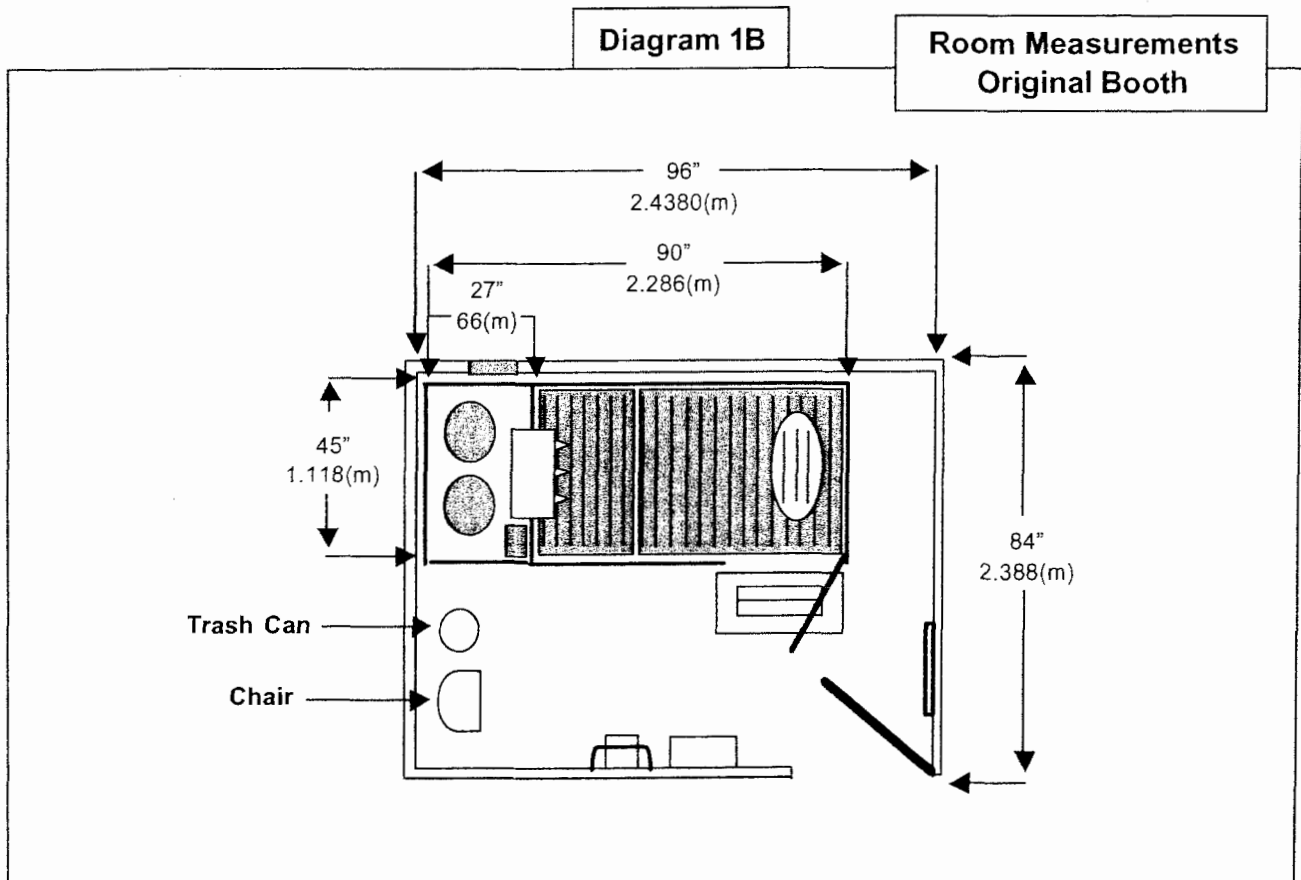
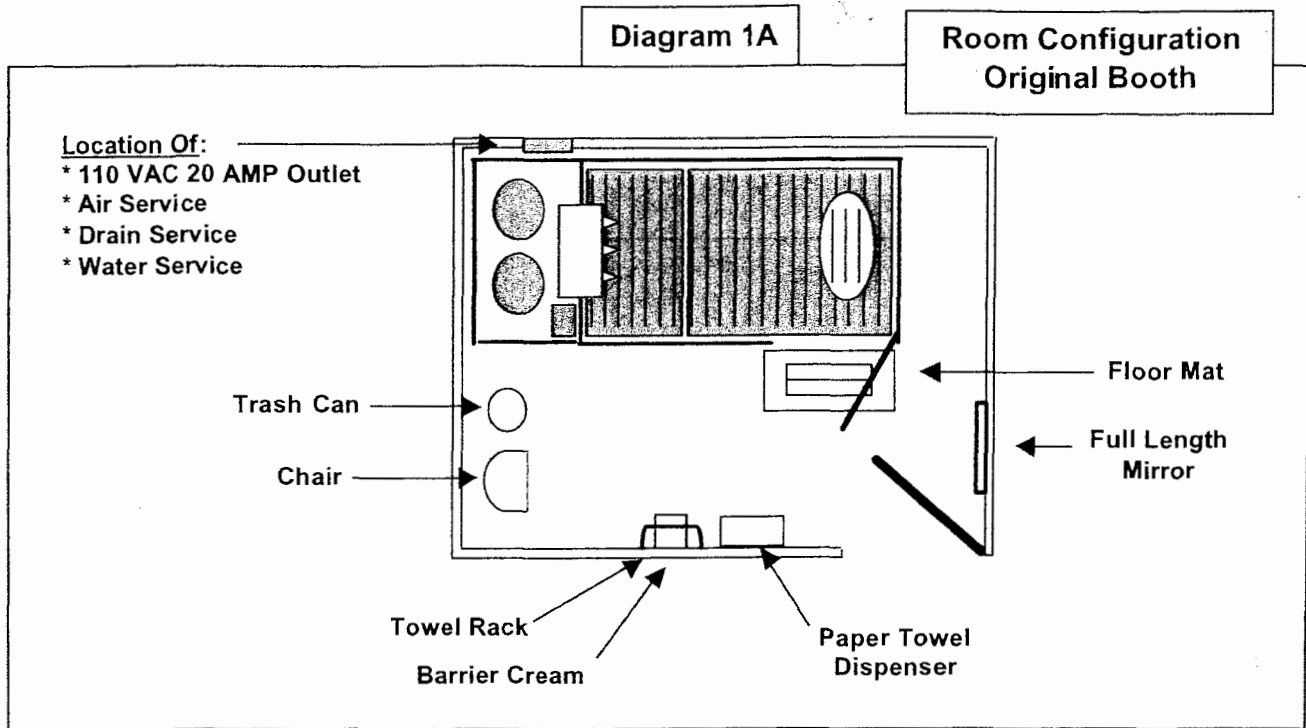

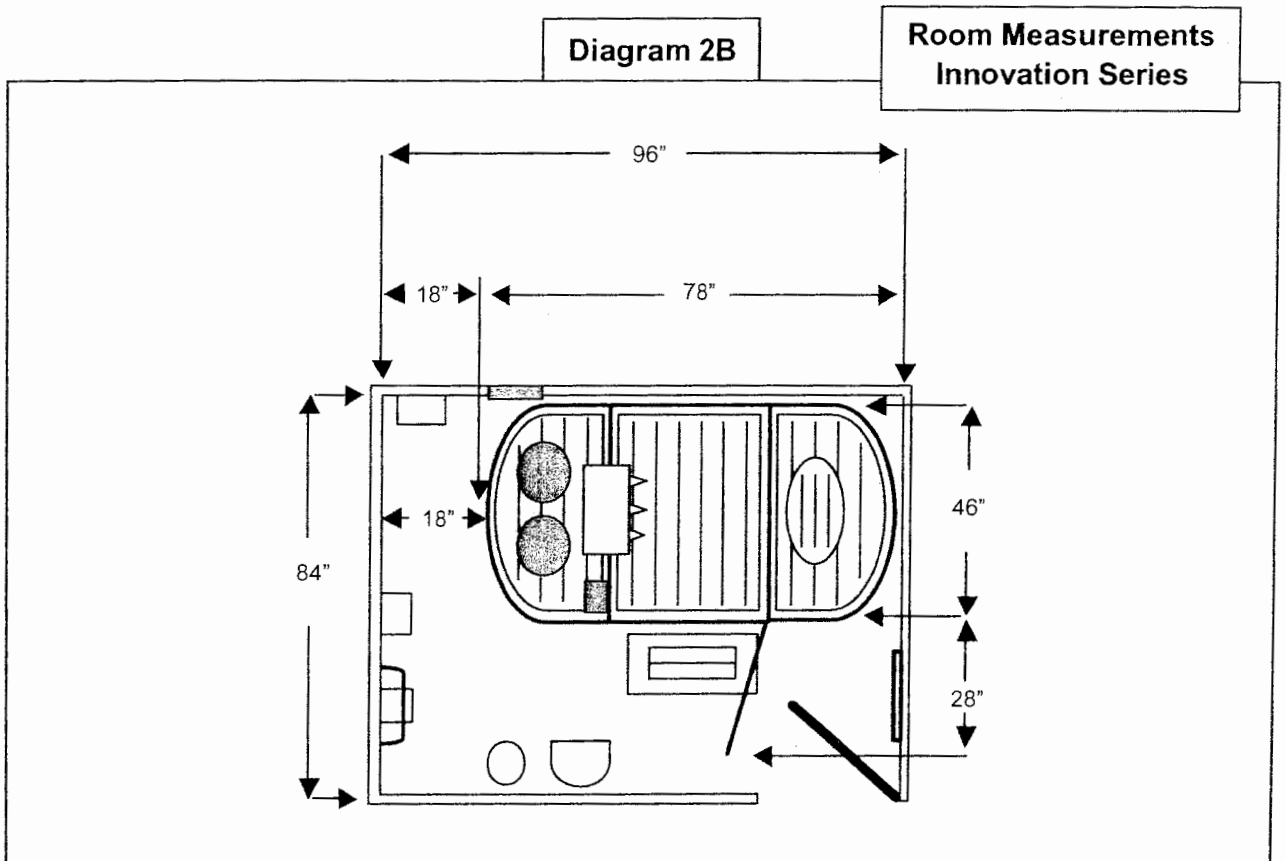
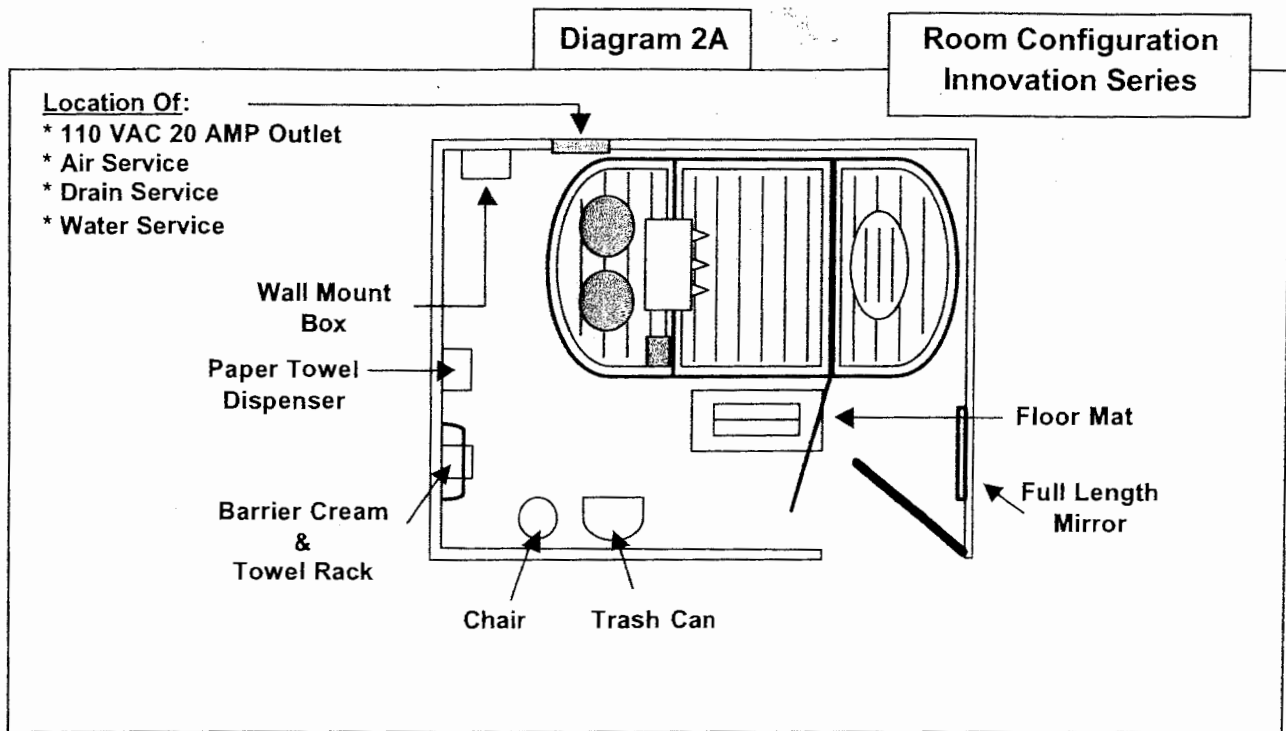

Shipping Configurations (actual box sizes and weights may vary)

Diagram 3

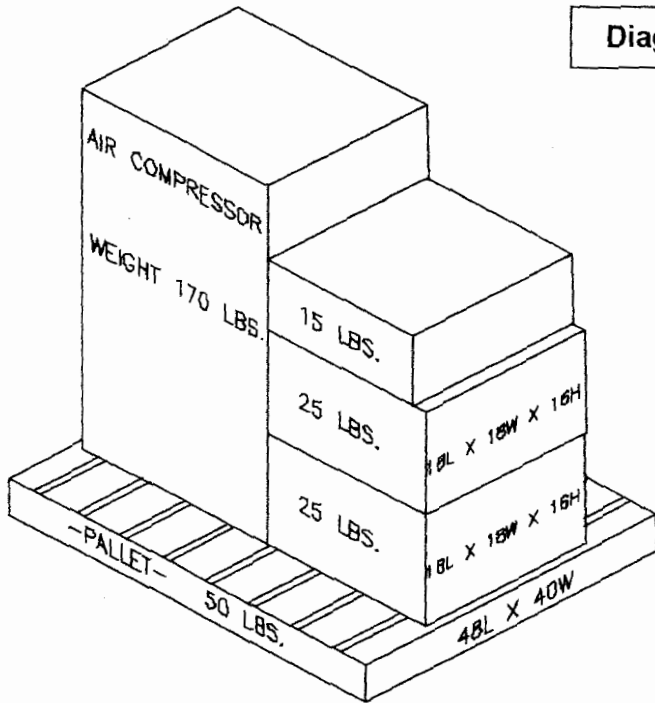

11 1/2" L X 11"W X 15"H

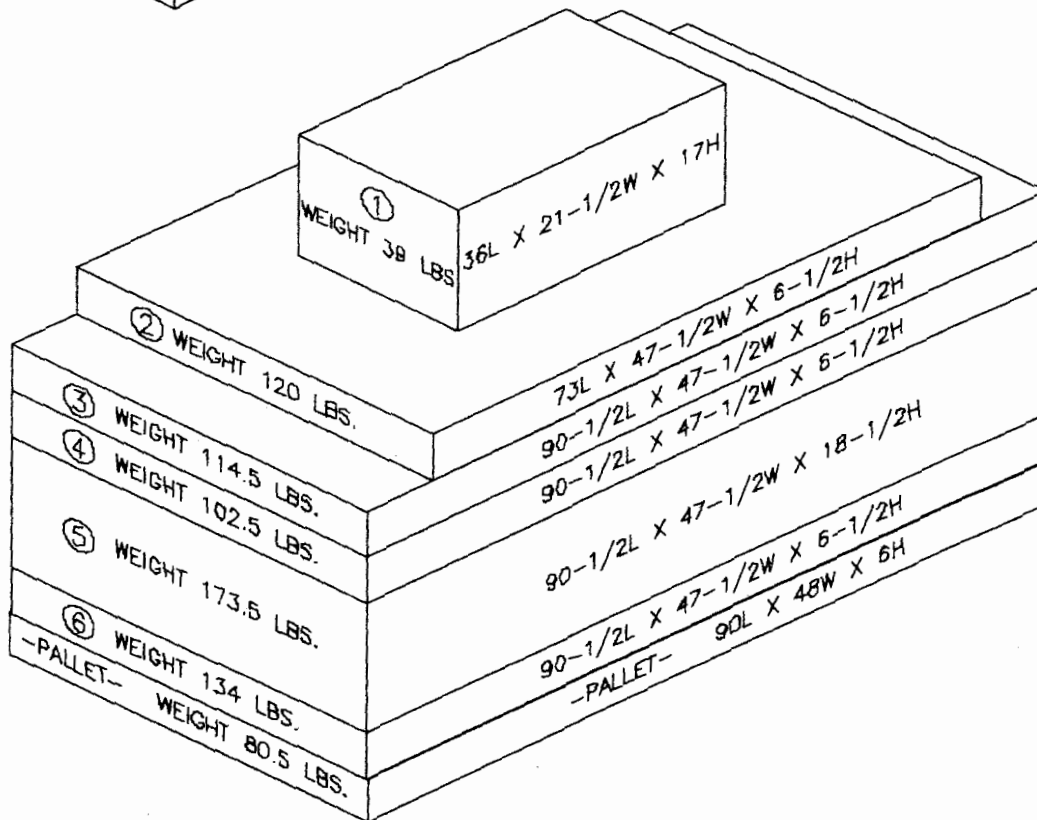

Electrical

Diagram 4

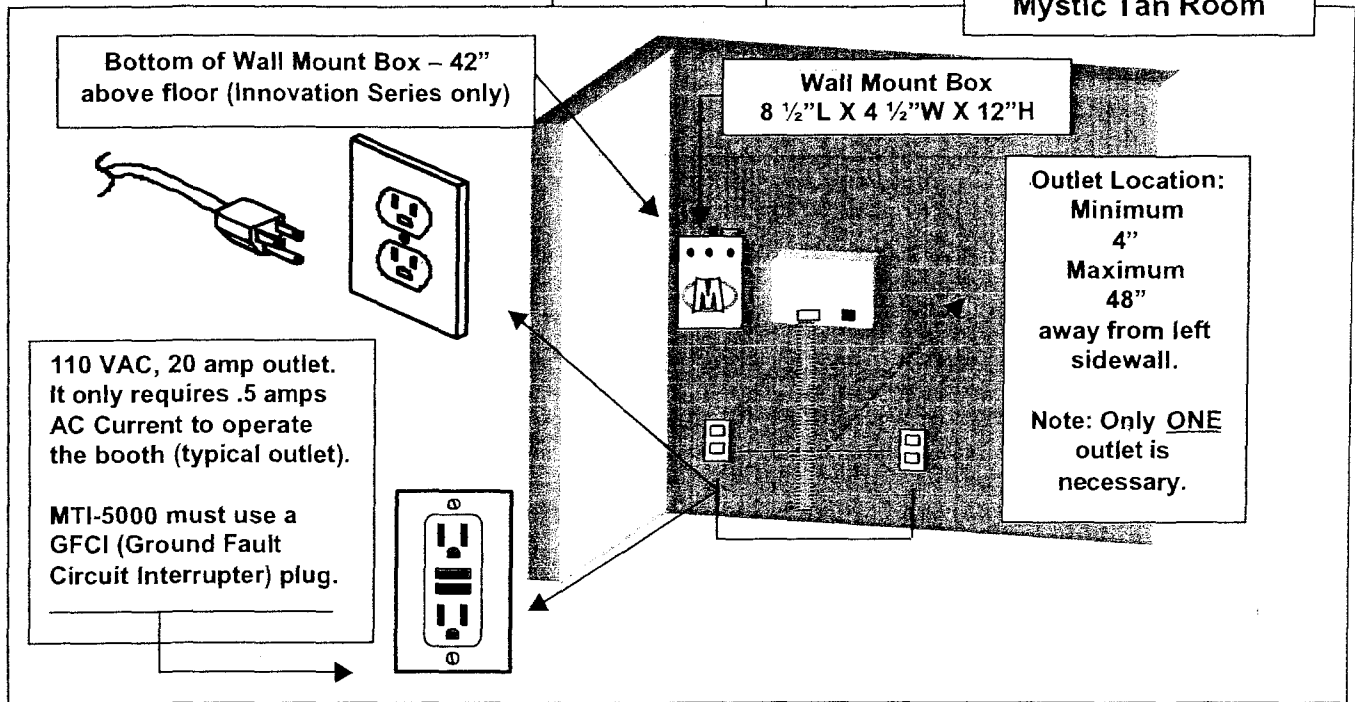
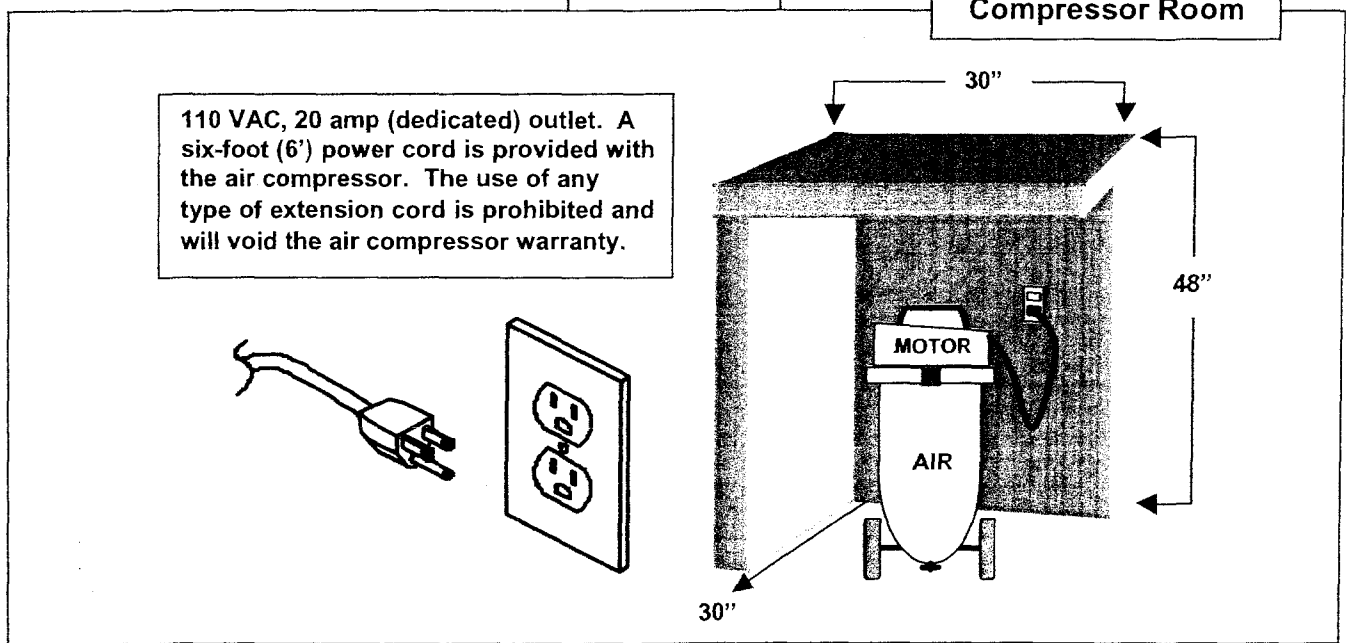

Diagram 5



Above Ground Plumbing

Diagram 6

Important (please read):
 The discharge pump (provided) is capable of pumping 12' in height and 48' in total length (60' of head pressure or approximately 30 PSI). The discharge pump will also remove water at a rate of 2.8 [GPM]. A six-foot (6') drain hose is provided to connect from the drain pump to the wall connection. *Not following these guidelines will cause premature pump failure. This in turn will result in the voiding of your pump warranty.*

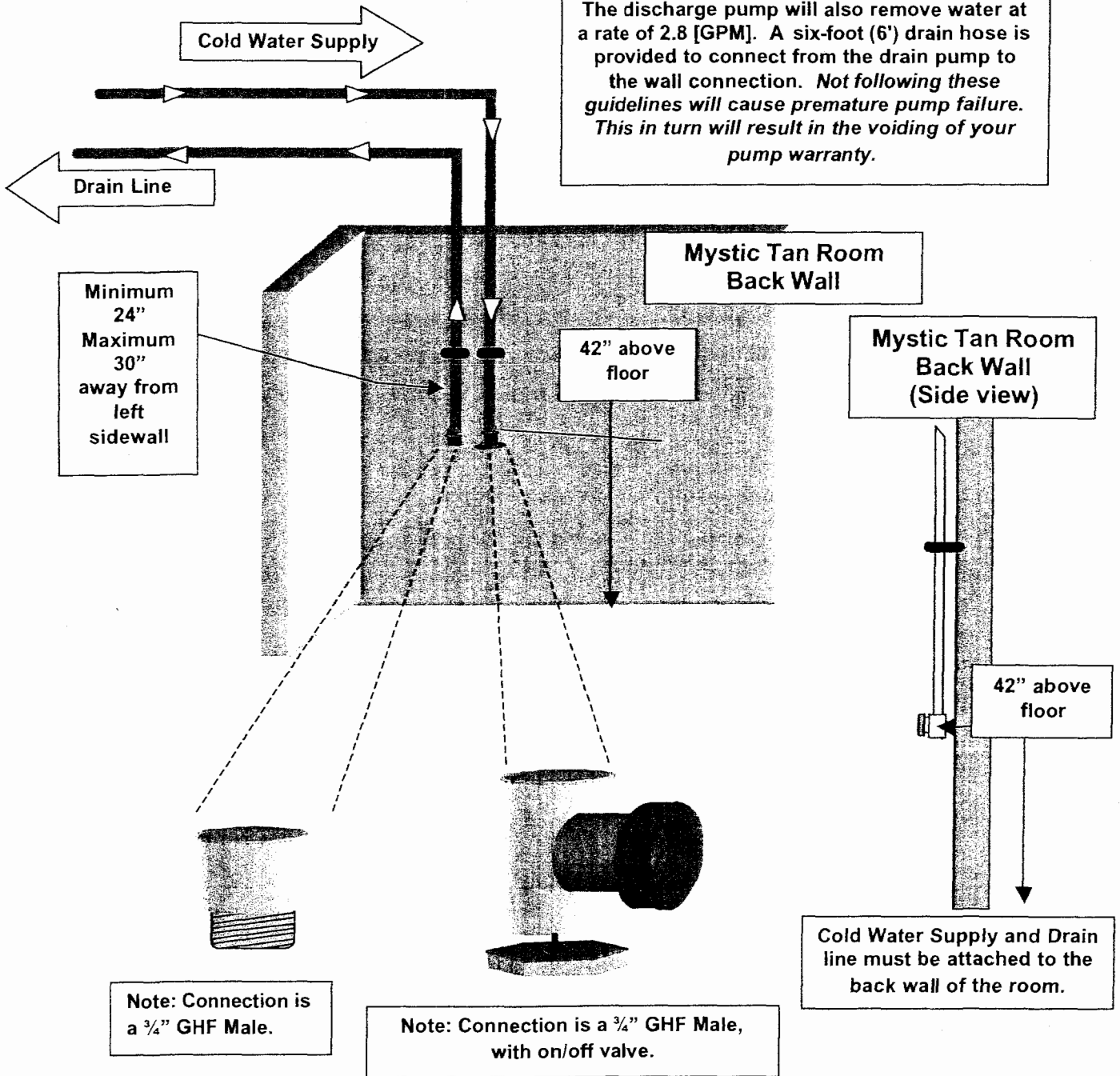

Minimum 24"
 Maximum 30"
 away from left
 sidewall

Mystic Tan Room
 Back Wall

42" above
 floor

Mystic Tan Room
 Back Wall
 (Side view)

42" above
 floor

Cold Water Supply and Drain
 line must be attached to the
 back wall of the room.

Note: Connection is a 3/4" GHF Male.

Note: Connection is a 3/4" GHF Male,
 with on/off valve.

Important: We recommend that the water supply to the Mystic Tan booth be turned off each night using the recommended shut-off valve.

Mystic Tan™ Pre-Installation

In-Ground Plumbing (New Construction)

Diagram 7

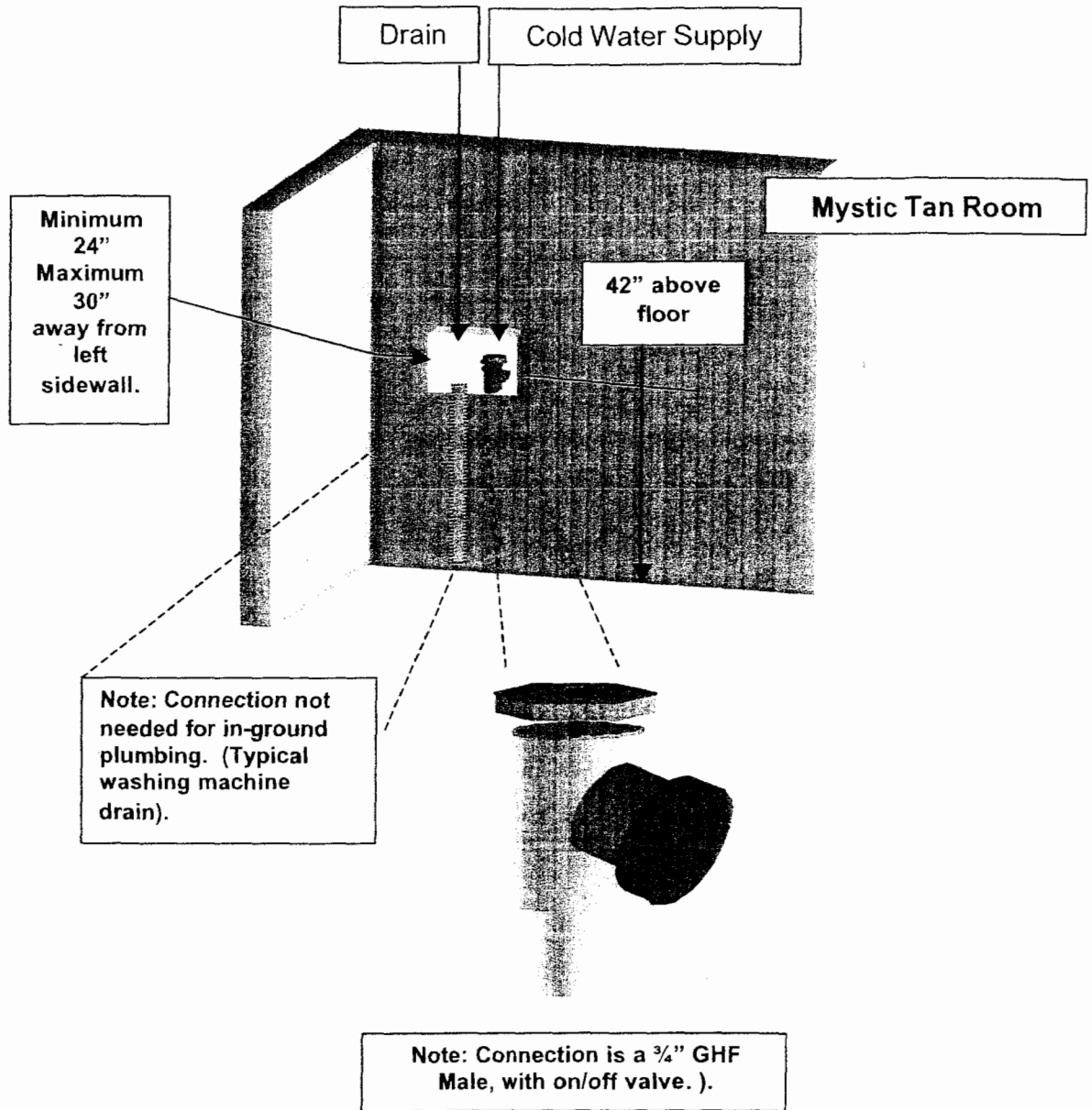

Important: We recommend that the water supply to the Mystic Tan booth be turned off each night using the recommended shut-off valve.

Mystic Tan™ Pre-Installation

Diagram 8A

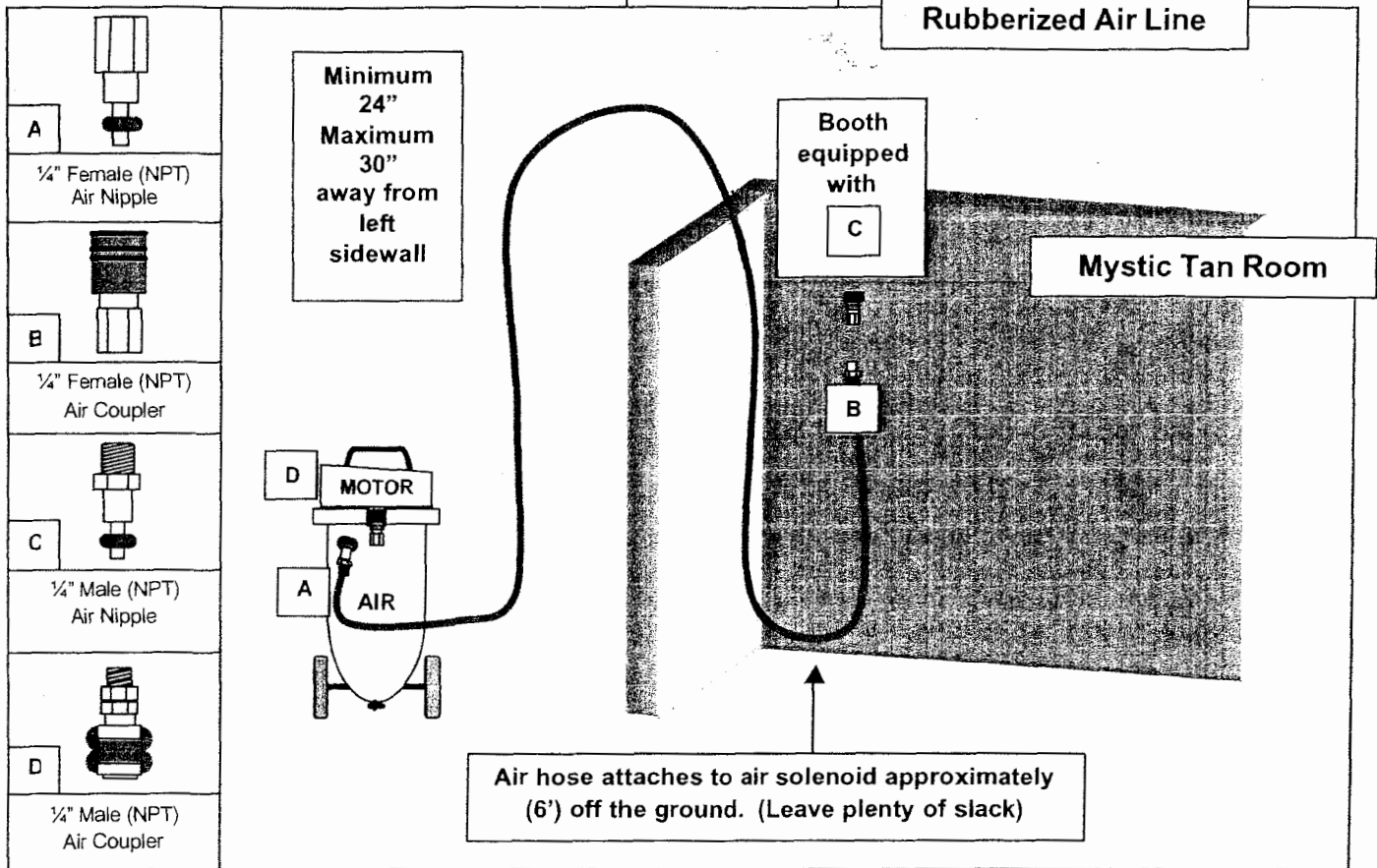
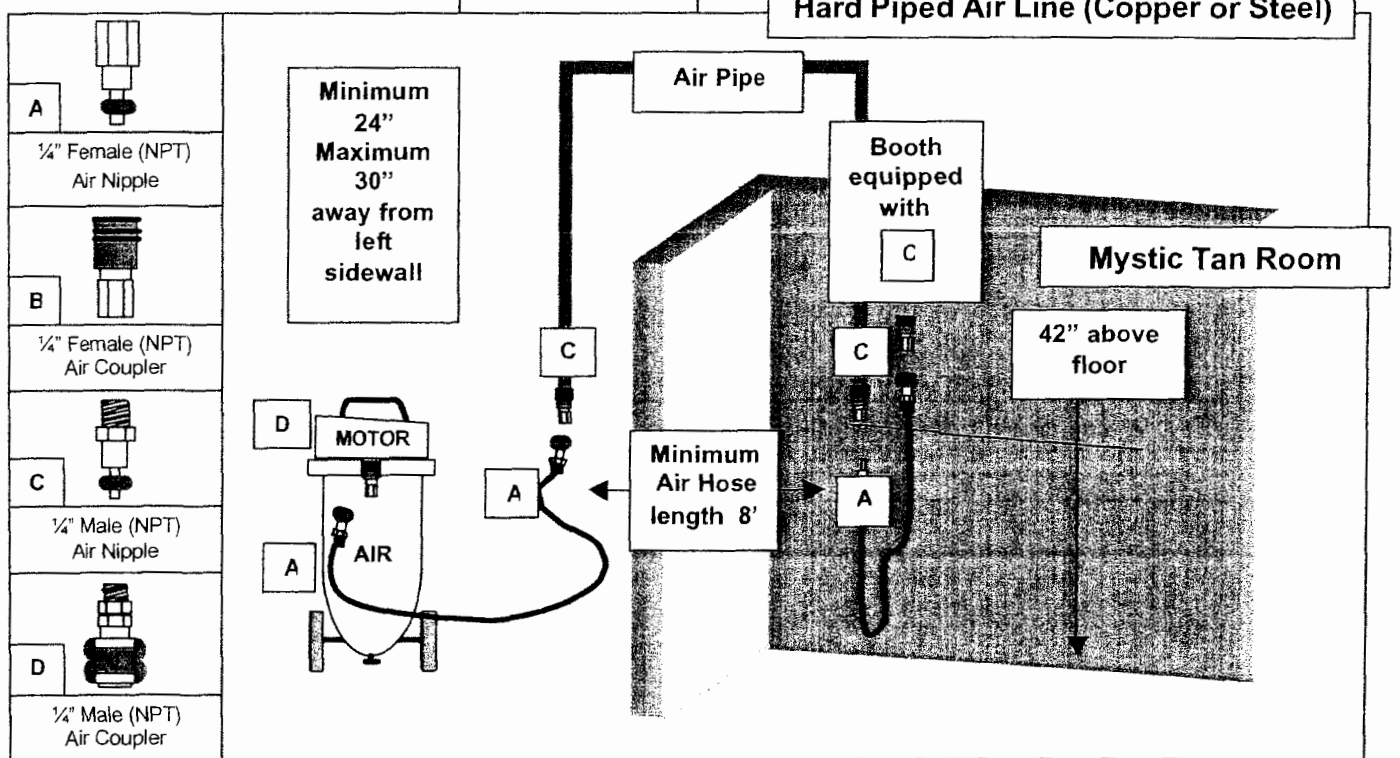
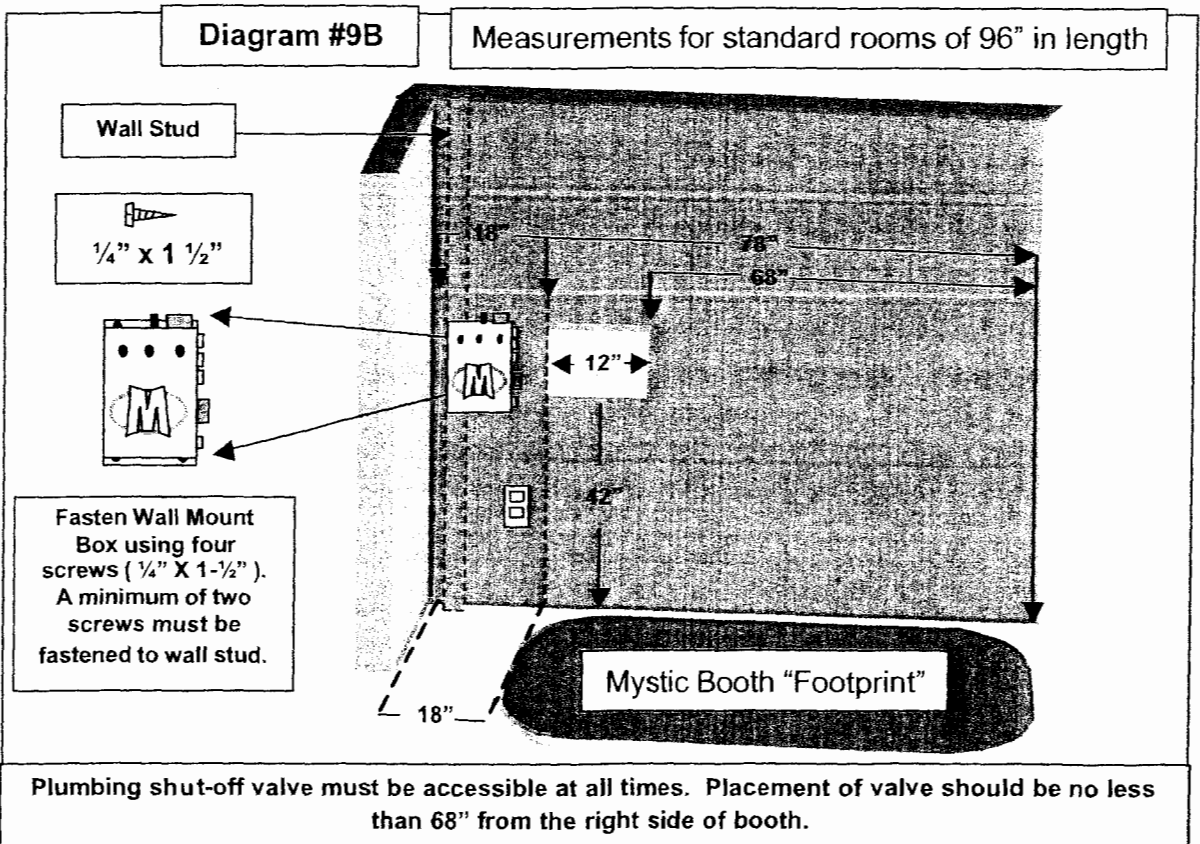
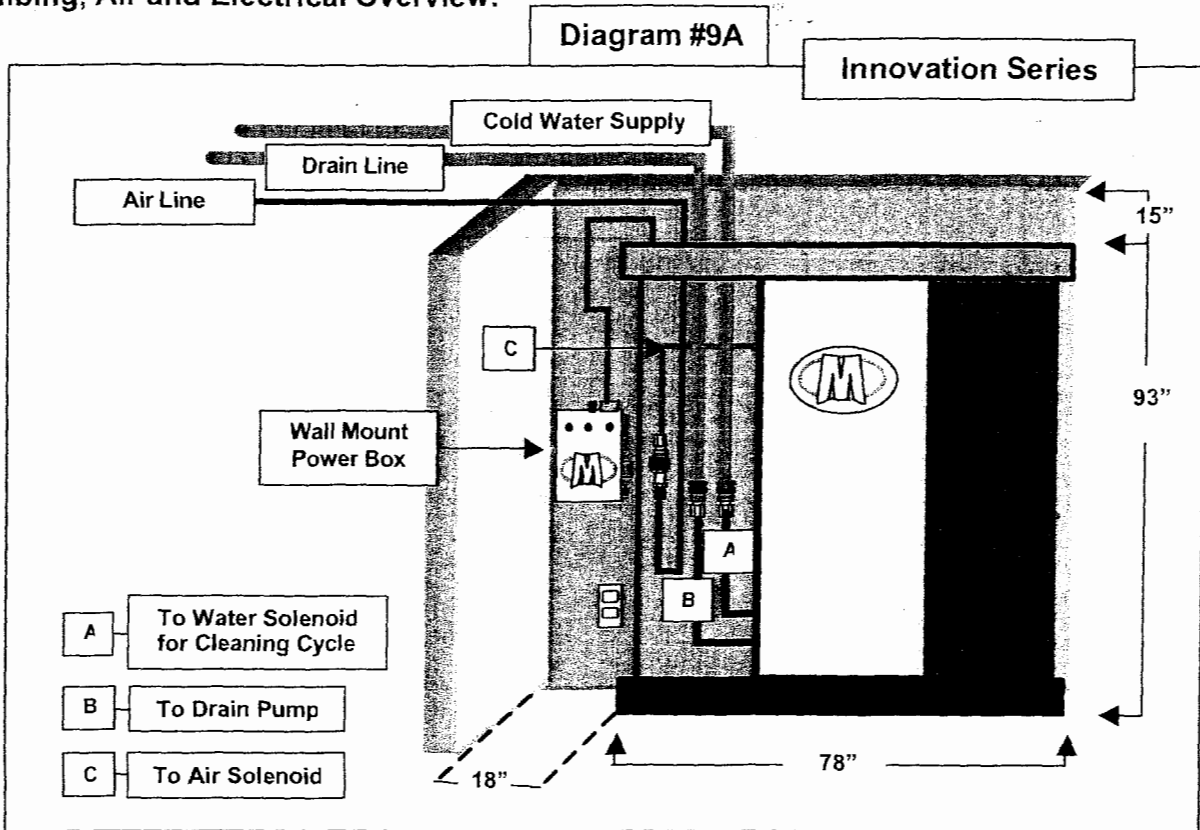

Diagram 8B



Mystic Tan™ Pre-Installation

Plumbing, Air and Electrical Overview:



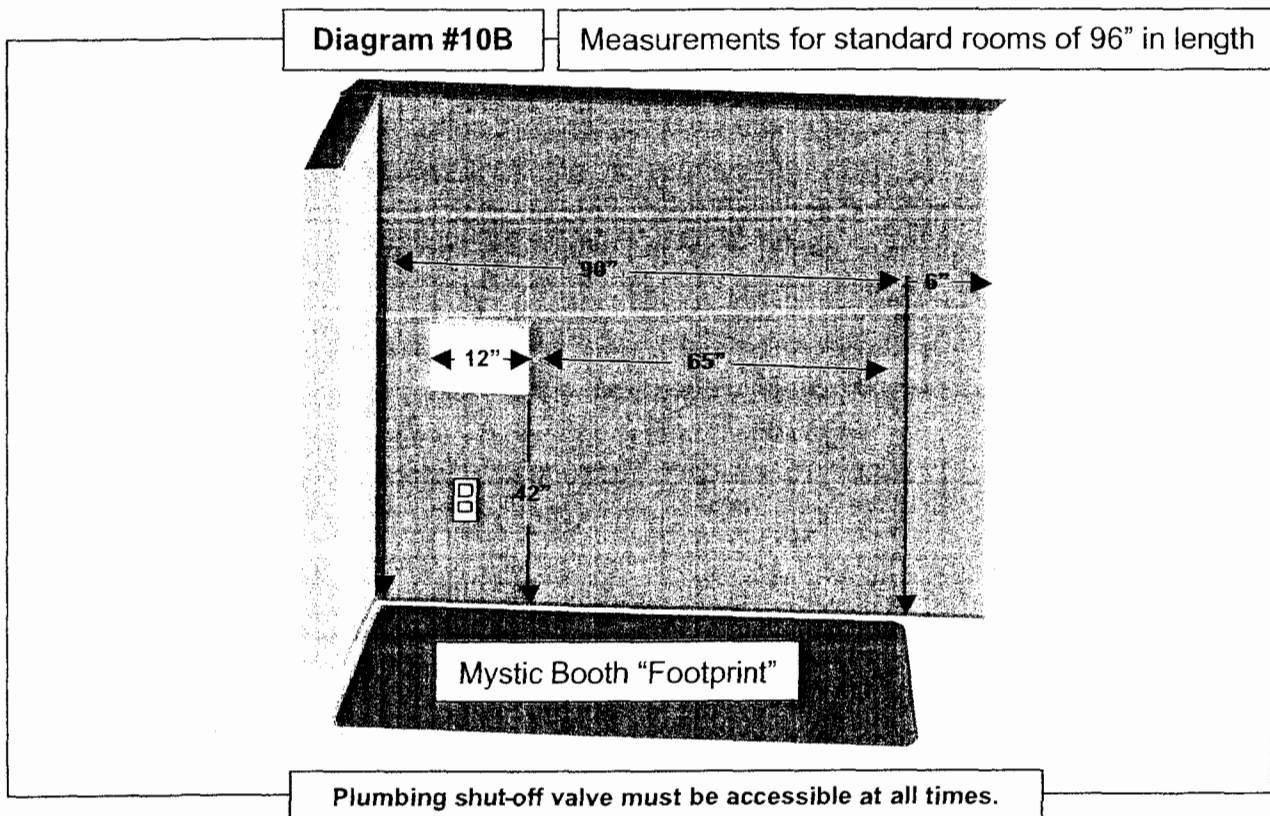
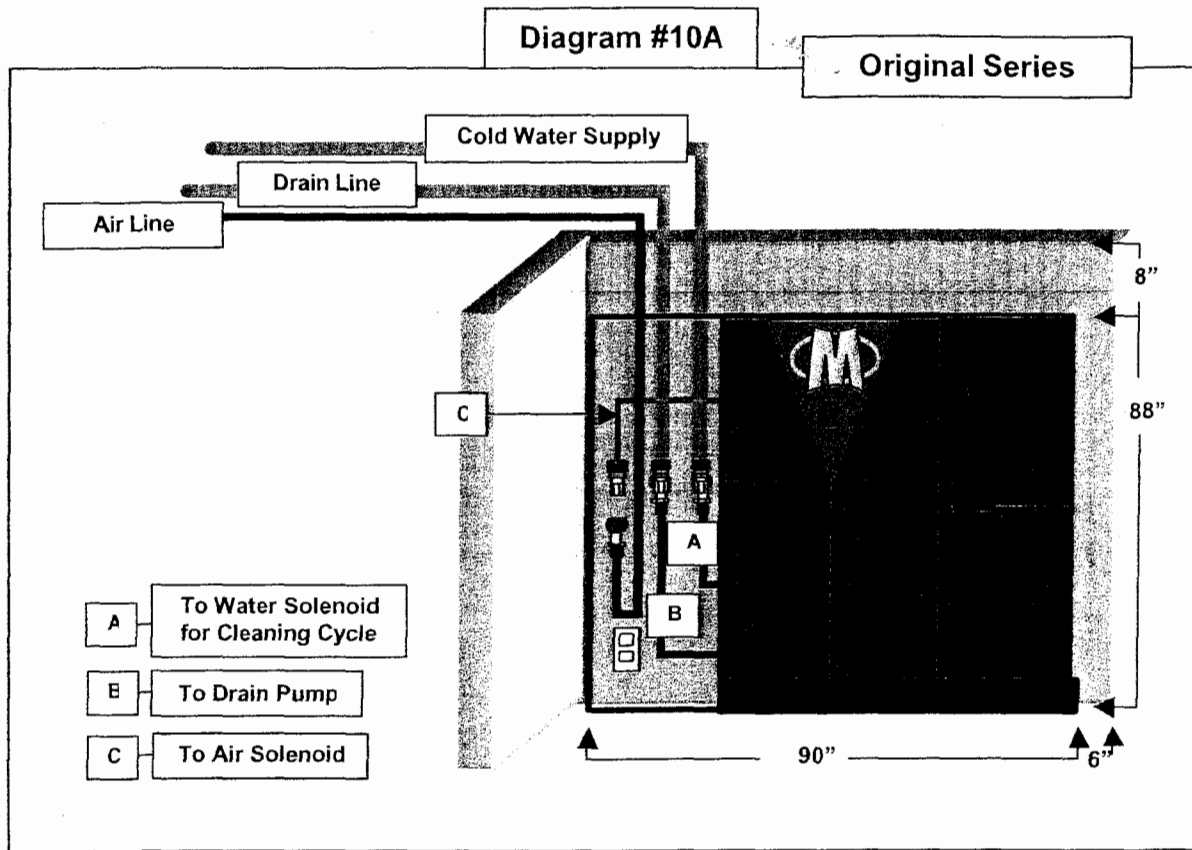

MYSTIC TAN SYSTEM MECHANICAL WALL

